



Paulmann



IP44



Info

www.paulmann.com

Paulmann Licht GmbH
Quezinger Feld 2
31832 Springe
Germany

www.paulmann.com

Art.-Nr.: 953.88

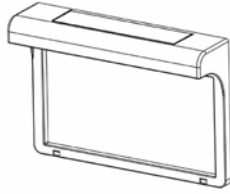

12345

67890

2x

abcde

1x



incl

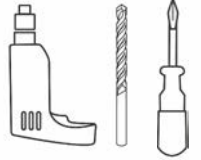

PYN 04/20



A

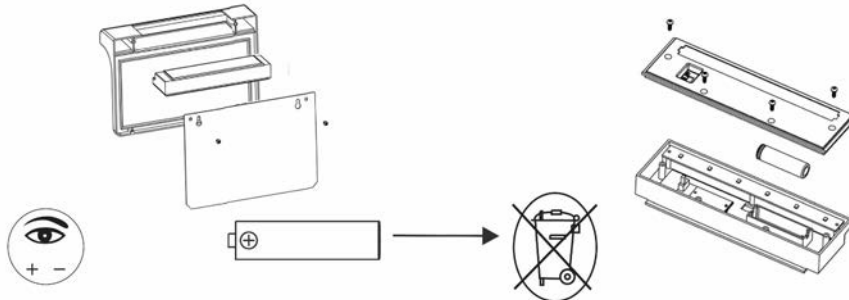

! only use rechargeable 1xNi-MH AA Battery (DC 1.2V, >600mAh)

B

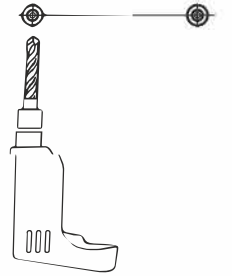

C

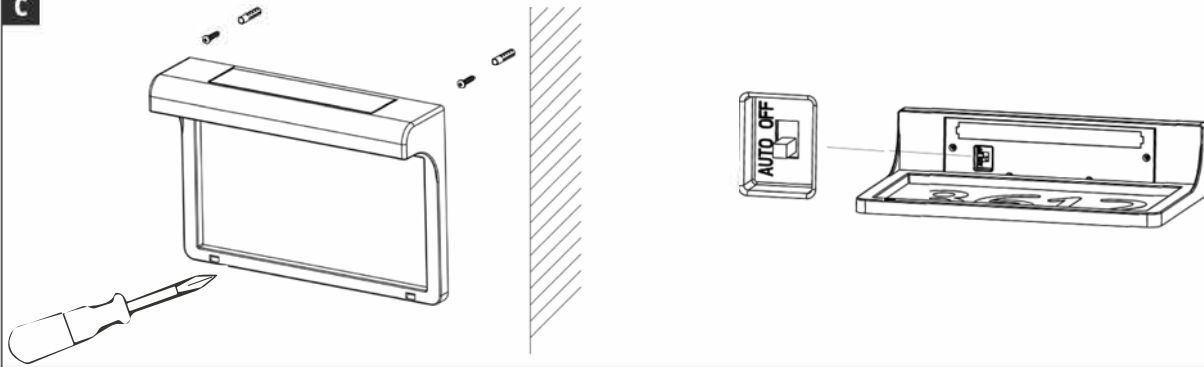

6-8h



4-6h



6-8h



< 4h

