

0
1
2
3
4
5
6
7
8
9
10
11
12
13
14
15
16
17
18
19
20



MONTAGEANLEITUNG



Meeth
FENSTER UND TÜREN



Schiebetüren

Stand: 10/2018

www.meeth.de

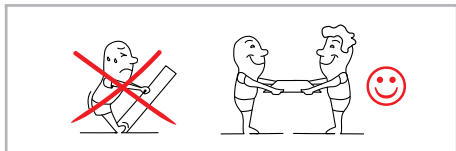
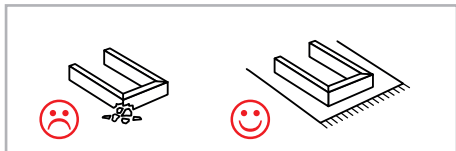



Werkzeuge  Wasserwaage (Länge) mind. 180 cm   Silikon



001 (4x)



018 (1x)
[4,50 m]



007 (1x)



008 (20x)



009 (8x)



003 (8x)

[35 mm]



004 (2x)

[30 mm]



005 (4x)



006 (2x)



[80 mm]

010 (8x)

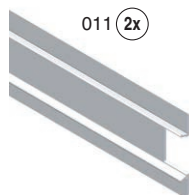

011 (2x)

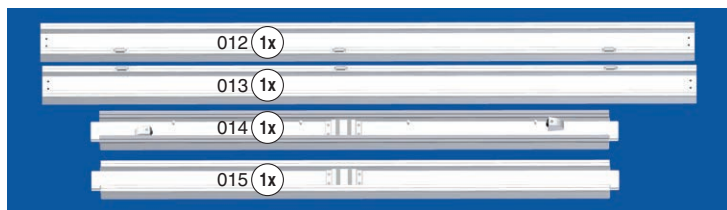

012 (1x)

013 (1x)

014 (1x)

015 (1x)

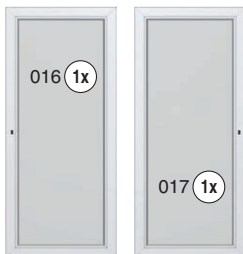

016 (1x)

017 (1x)

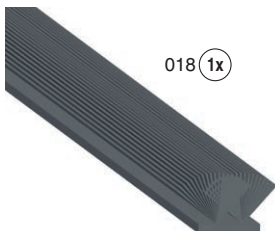

018 (1x)



019 (2x)

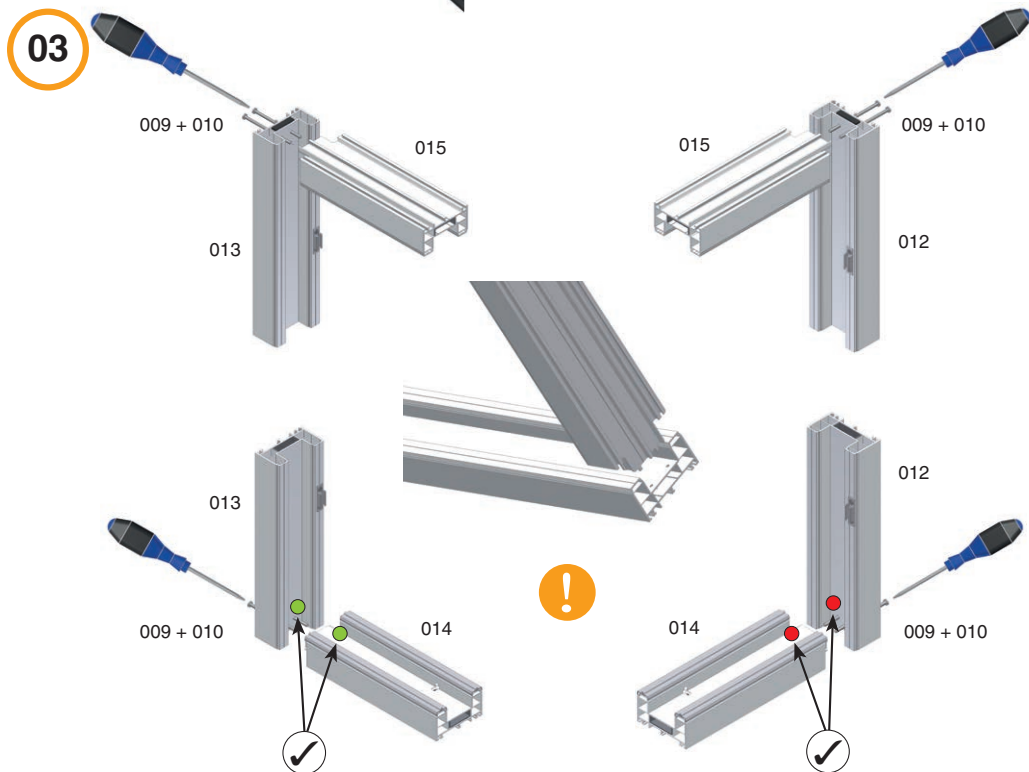
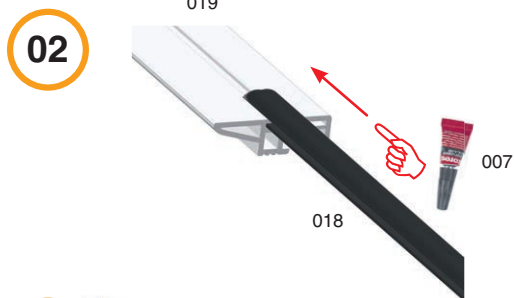
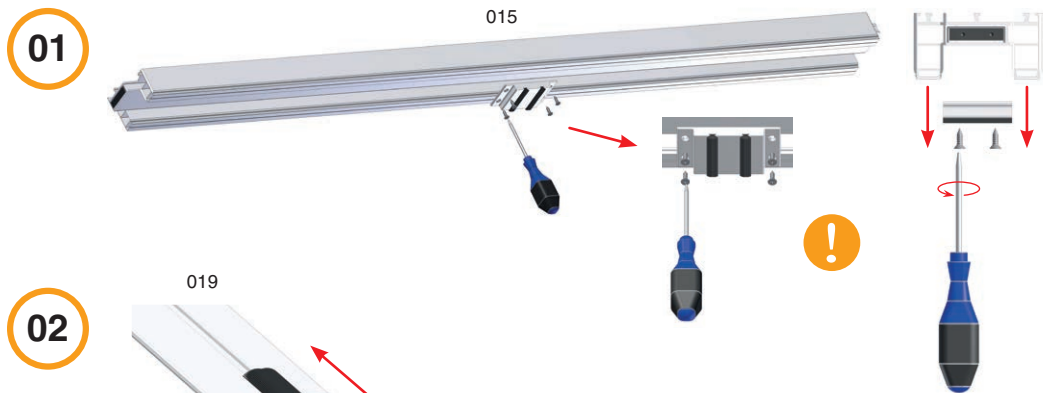

04

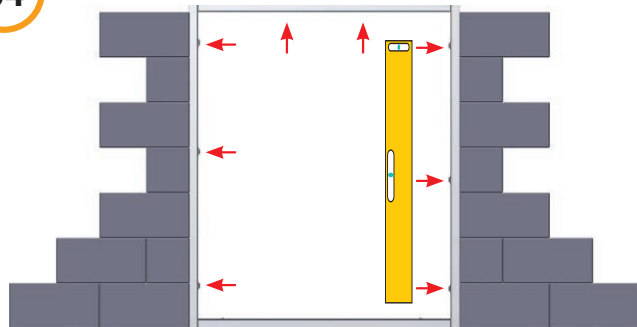

Wasserwaage (Länge) mind. 180 cm

Montagehilfe:
3 Stützeleisten

A = B = C

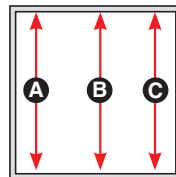

Diagonale
Vermessung

d1 = d2

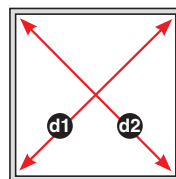

05



06

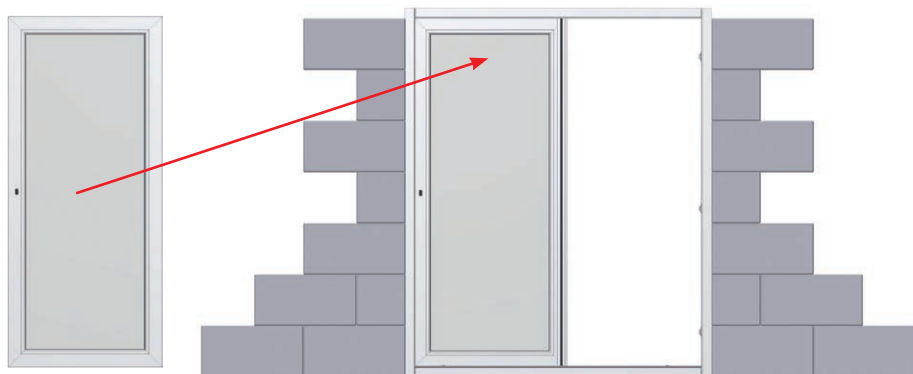

07

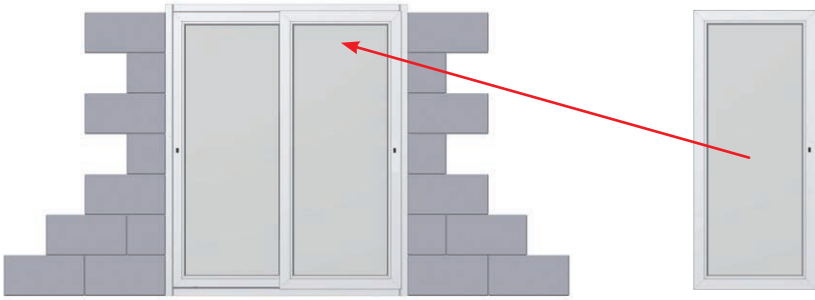

08



AUSHEBESICHERUNGEN: A) Höhe 1,90 m = 2 Stück montieren B) Höhe größer als 1,90 m = 4 Stück montieren

09

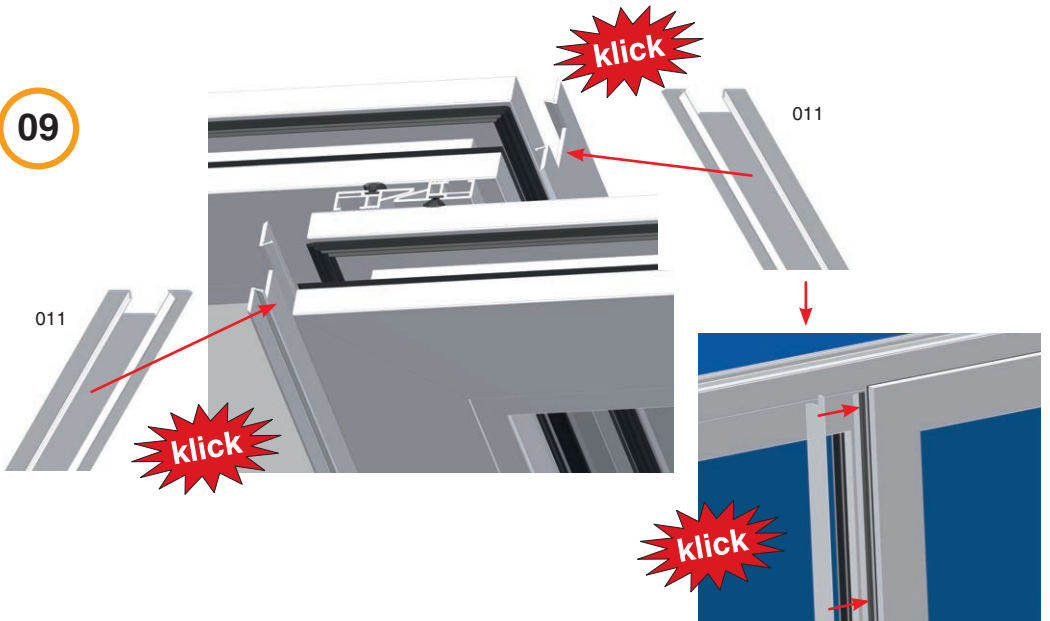

10

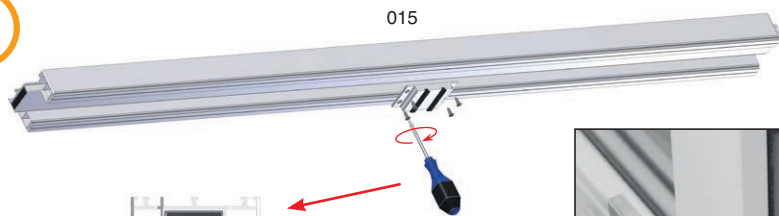

Empfohlener Überschlag
oben und unten ca. 1 cm!

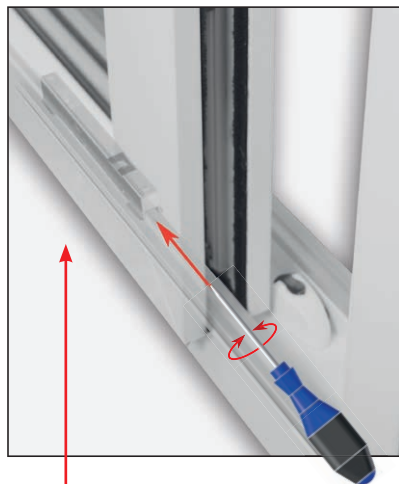

Höheneinstellung der Laufwagen im
Schiebeelement-Flügel mit Hilfe eines
Schraubendrehers (Größe PZ2).

Im Uhrzeigersinn = hoch ▲
Gegen den Uhrzeigersinn = runter ▼

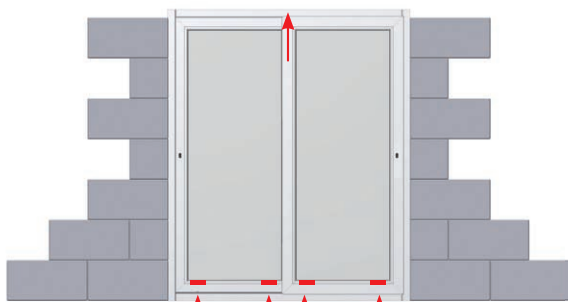

1 2 3 4 = Positionen der 4 Laufwagen



11

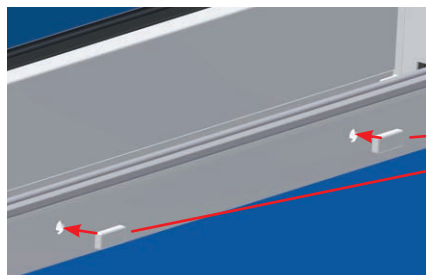

005

12

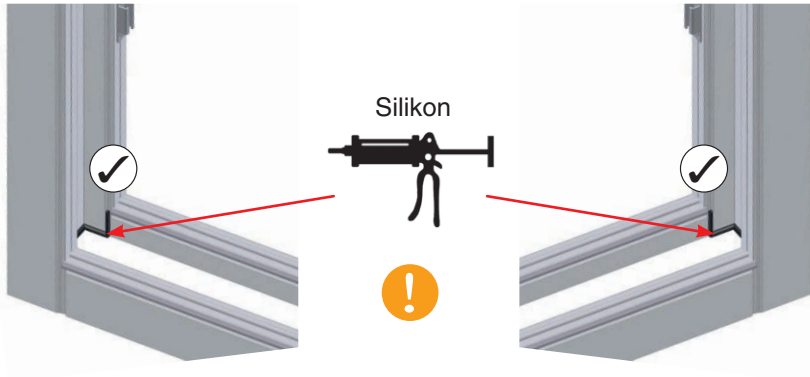

Stopper Einbau



Stopper positionieren (006)



Stopper einsetzen



Gummiabdeckung **nur anheben**



Schrauben positionieren (004)



Stopper mit Schraube befestigen



Gummiabdeckung schließen



Die neue **Meeth App** jetzt kostenlos downloaden:



Josef Meeth Fensterfabrik GmbH & Co. KG
54533 Laufeld ▪ Telefon: 06572 / 81-0 ▪ www.meeth.de